

For Official Use Only 請勿填寫此欄	Application No. 申請編號	
	Date Received 收到日期	

- The completed form and supporting documents (if any) should be sent to the Secretary, Town Planning Board (the Board), 15/F, North Point Government Offices, 333 Java Road, North Point, Hong Kong.
申請人須把填妥的申請表格及其他支持申請的文件 (倘有), 送交香港北角渣華道 333 號北角政府合署 15 樓城市規劃委員會(下稱「委員會」)秘書收。
- Please read the "Guidance Notes" carefully before you fill in this form. The document can be downloaded from the Board's website at <http://www.tpb.gov.hk/>. It can also be obtained from the Secretariat of the Board at 15/F, North Point Government Offices, 333 Java Road, North Point, Hong Kong (Tel: 2231 4810 or 2231 4835), and the Planning Enquiry Counters of the Planning Department (Hotline: 2231 5000) (17/F, North Point Government Offices, 333 Java Road, North Point, Hong Kong and 14/F, Sha Tin Government Offices, 1 Sheung Wo Che Road, Sha Tin, New Territories).
請先細閱《申請須知》的資料單張, 然後填寫此表格。該份文件可從委員會的網頁下載 (網址: <http://www.tpb.gov.hk/>), 亦可向委員會秘書處 (香港北角渣華道 333 號北角政府合署 15 樓 - 電話: 2231 4810 或 2231 4835) 及規劃署的規劃資料查詢處 (熱線: 2231 5000) (香港北角渣華道 333 號北角政府合署 17 樓及新界沙田上禾輦路 1 號沙田政府合署 14 樓) 索取。
- This form can be downloaded from the Board's website, and obtained from the Secretariat of the Board and the Planning Enquiry Counters of the Planning Department. The form should be typed or completed in block letters. The processing of the application may be refused if the required information or the required copies are incomplete.
此表格可從委員會的網頁下載, 亦可向委員會秘書處及規劃署的規劃資料查詢處索取。申請人須以打印方式或以正楷填寫表格。如果申請人所提交的資料或文件副本不齊全, 委員會可拒絕處理有關申請。

1. Name of Applicant 申請人姓名/名稱
(<input checked="" type="checkbox"/> Mr. 先生 / <input type="checkbox"/> Mrs. 夫人 / <input type="checkbox"/> Miss 小姐 / <input type="checkbox"/> Ms. 女士 / <input checked="" type="checkbox"/> Company 公司 / <input type="checkbox"/> Organisation 機構)
Bright Spark Ventures Limited

2. Name of Authorised Agent (if applicable) 獲授權代理人姓名/名稱 (如適用)
(<input type="checkbox"/> Mr. 先生 / <input type="checkbox"/> Mrs. 夫人 / <input type="checkbox"/> Miss 小姐 / <input type="checkbox"/> Ms. 女士 / <input checked="" type="checkbox"/> Company 公司 / <input type="checkbox"/> Organisation 機構)
RHL Surveyors Limited

3. Application Site 申請地點	
(a) Full address / location / demarcation district and lot number (if applicable) 詳細地址/地點/丈量約份及地段號碼 (如適用)	Portion of Factory Unit No.6 on G/F, Kowloon Bay Industrial Centre, No.15 Wang Hoi Road, Kowloon (New Kowloon Inland Lot No. 5833)
(b) Site area and/or gross floor area involved 涉及的地盤面積及/或總樓面面積	<input type="checkbox"/> Site area 地盤面積sq.m 平方米 <input type="checkbox"/> About 約 <input checked="" type="checkbox"/> Gross floor area 總樓面面積 29.0sq.m 平方米 <input checked="" type="checkbox"/> About 約
(c) Area of Government land included (if any) 所包括的政府土地面積 (倘有)	Not Applicable sq.m 平方米 <input type="checkbox"/> About 約

6. Type(s) of Application 申請類別

- Type (i) Change of use within existing building or part thereof
第(i)類 更改現有建築物或其部分內的用途
- Type (ii) Diversion of stream / excavation of land / filling of land / filling of pond as required under Notes of Statutory Plan(s)
第(ii)類 根據法定圖則《註釋》內所要求的河道改道／挖土／填土／填塘工程
- Type (iii) Public utility installation / Utility installation for private project
第(iii)類 公用事業設施裝置/私人發展計劃的公用設施裝置
- Type (iv) Minor relaxation of stated development restriction(s) as provided under Notes of Statutory Plan(s)
第(iv)類 略為放寬於法定圖則《註釋》內列明的發展限制
- Type (v) Use / development other than (i) to (iii) above
第(v)類 上述的(i)至(iii)項以外的用途／發展

Note 1: May insert more than one 「✓」.

註 1：可在多於一個方格內加上「✓」號

Note 2: For Development involving columbarium use, please complete the table in the Appendix.

註 2：如發展涉及靈灰安置所用途，請填妥於附件的表格。

(i) For Type (i) application 供第(i)類申請

(a) Total floor area involved 涉及的總樓面面積	29.0 sq.m 平方米		
(b) Proposed use(s)/development 擬議用途/發展	Shop and Services. (If there are any Government, institution or community facilities, please illustrate on plan and specify the use and gross floor area) (如有任何政府、機構或社區設施，請在圖則上顯示，並註明用途及總樓面面積)		
(c) Number of storeys involved 涉及層數		Number of units involved 涉及單位數目	1
(d) Proposed floor area 擬議樓面面積	Domestic part 住用部分		sq.m 平方米 <input type="checkbox"/> About 約
	Non-domestic part 非住用部分..... 29.0		sq.m 平方米 <input checked="" type="checkbox"/> About 約
	Total 總計		29.0 sq.m 平方米 <input checked="" type="checkbox"/> About 約
(e) Proposed uses of different floors (if applicable) 不同樓層的擬議用途(如適用) <small>(Please use separate sheets if the space provided is insufficient) (如所提供的空間不足，請另買說明)</small>	Floor(s) 樓層	Current use(s) 現時用途	Proposed use(s) 擬議用途
	N.A.	Not Applicable	Not Applicable

Gist of Application 申請摘要

(Please provide details in both English and Chinese as far as possible. This part will be circulated to relevant consultees, uploaded to the Town Planning Board's Website for browsing and free downloading by the public and available at the Planning Enquiry Counters of the Planning Department for general information.)

(請盡量以英文及中文填寫。此部分將會發送予相關諮詢人士、上載至城市規劃委員會網頁供公眾免費瀏覽及下載及於規劃署規劃資料查詢處供一般參閱。)

Application No. 申請編號	(For Official Use Only) (請勿填寫此欄)		
Location/address 位置/地址	Portion of Factory Unit No.6 on G/F, Kowloon Bay Industrial Centre, No.15 Wang Hoi Road, Kowloon 九龍宏開道15號九龍灣工業中心地下6號單位(部分)		
Site area 地盤面積		sq. m 平方米 <input type="checkbox"/> About 約	
	(includes Government land of 包括政府土地	sq. m 平方米 <input type="checkbox"/> About 約)	
Plan 圖則	Approved Ngau Tau Kok & Kowloon Bay Outline Zoning Plan No. S/K13/32 牛頭角及九龍灣分區計劃大綱核准圖編號S/K13/32		
Zoning 地帶	"Other Specified Uses" annotated "Business" 其他指定用途 (商貿)		
Applied use/ development 申請用途/發展	Shop and Services 商店及服務行業		
(i) Gross floor area and/or plot ratio 總樓面面積及/或 地積比率		sq.m 平方米	Plot Ratio 地積比率
	Domestic 住用	<input type="checkbox"/> About 約 <input type="checkbox"/> Not more than 不多於	<input type="checkbox"/> About 約 <input type="checkbox"/> Not more than 不多於
	Non-domestic 非住用	29.0 <input checked="" type="checkbox"/> About 約 <input type="checkbox"/> Not more than 不多於	<input type="checkbox"/> About 約 <input type="checkbox"/> Not more than 不多於
(ii) No. of blocks 幢數	Domestic 住用		
	Non-domestic 非住用		
	Composite 綜合用途		

Site Plan

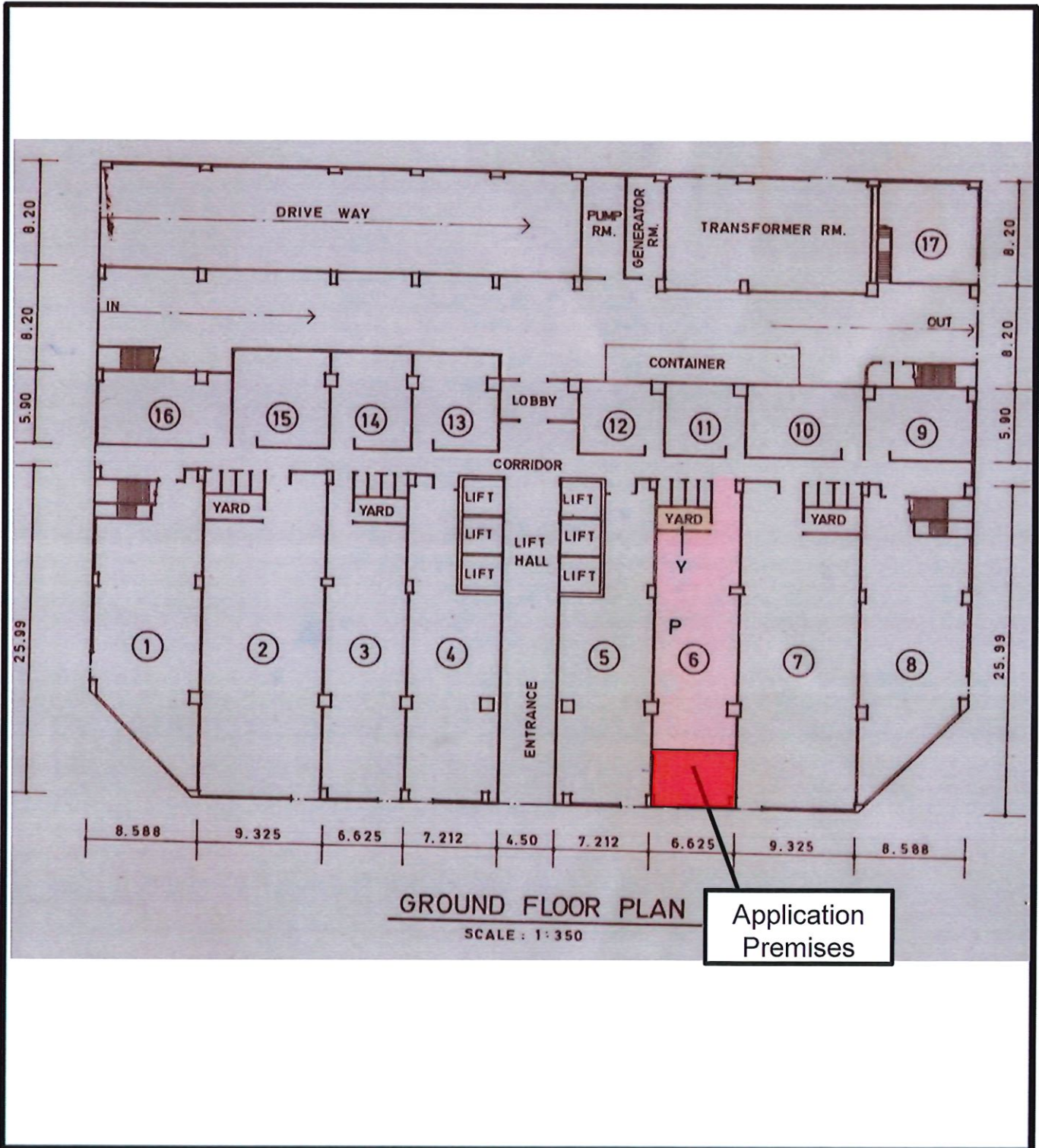

Site Plan

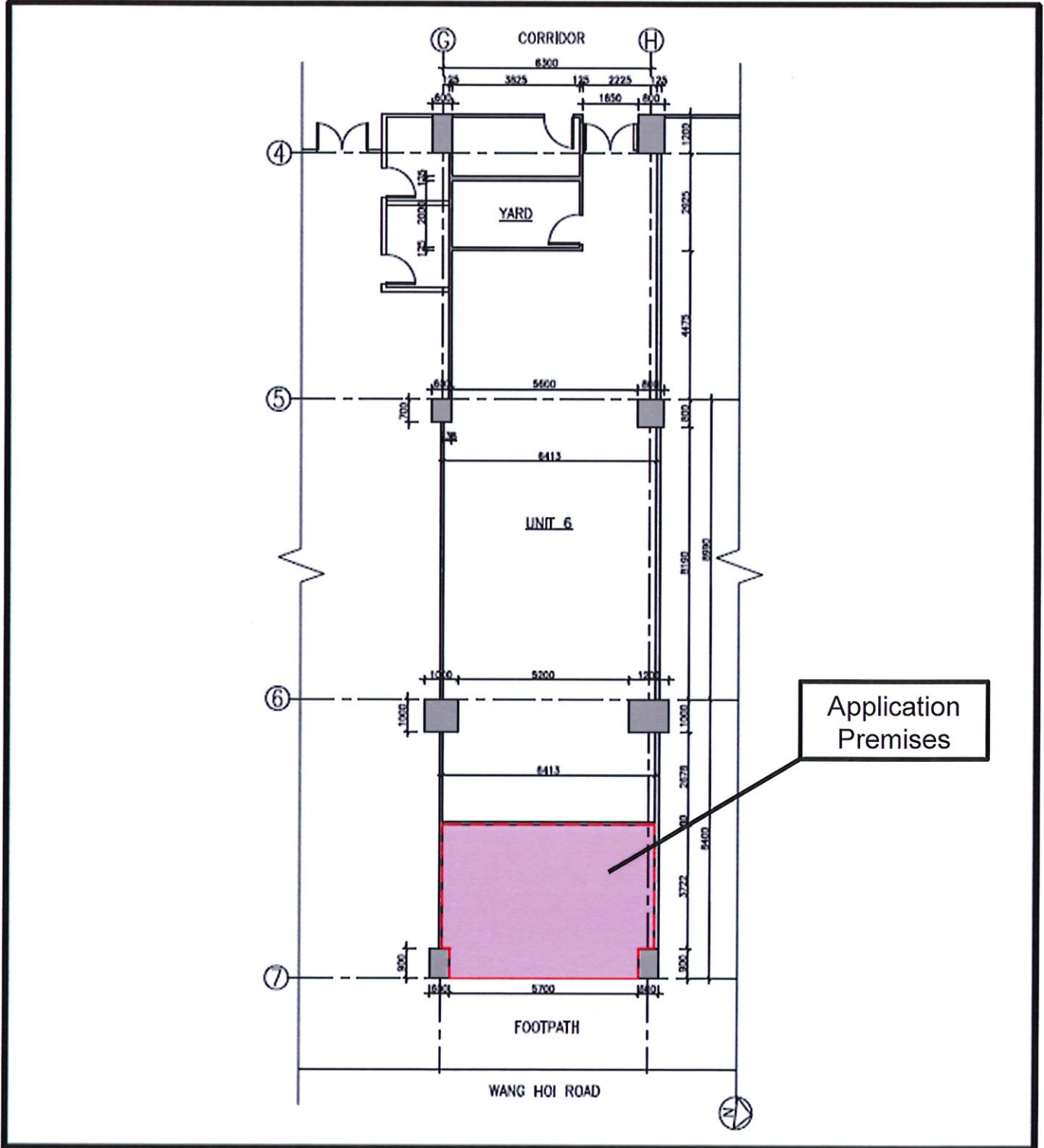

Not to scale – for identification purpose only

永利行集團成員 | Member of RHL International